

REV	LOCATIONS	DESCRIPTION	DATE	REVISER	APPD
1	△	1.Cancel the insertion gap 2.Update dimensions and tolerances	27/NOV/24	MATT	LEO

**SPECIFICATIONS**

**Electrical**

Current Rating: 2.0A AC(rms)/DC  
Voltage Rating: 250V AC(rms)/DC  
Contact Resistance: 20 mΩ Max  
Insulation Resistance: 1000 MΩ MIN  
Withstanding Voltage: 500V AC r.m.s  
Temperature Range—Operating: -40°C~+105°C  
**Material and Plating**  
Housing: PA9T ( UL 94V-0)  
Contact: Brass/Tin plated

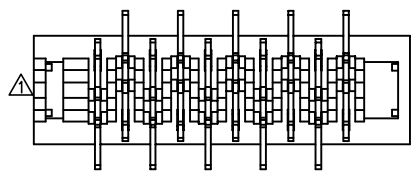
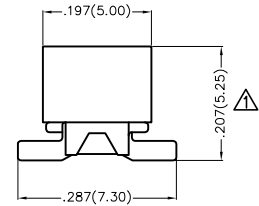
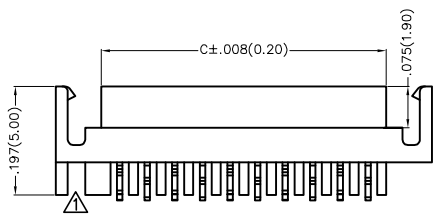
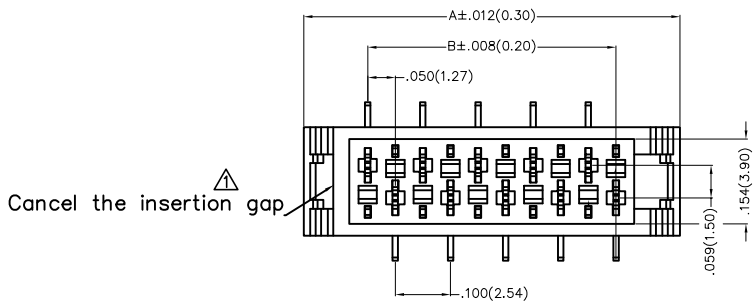

Circuits (n)	Part No.	Dimensions(mm)			Q'ty/Tube
		A △	B	C	
4	FID12707-044R1L	.382(9.71)	.150(3.81)	.217(5.50)	59
6	FID12707-064R1L	.482(12.25)	.250(6.35)	.317(8.04)	47
8	FID12707-084R1L	.582(14.79)	.350(8.89)	.417(10.58)	39
10	FID12707-104R1L	.682(17.33)	.450(11.43)	.517(13.12)	33
12	FID12707-124R1L	.782(19.87)	.550(13.97)	.617(15.66)	29
14	FID12707-144R1L	.882(22.41)	.650(16.51)	.717(18.20)	25
16	FID12707-164R1L	.982(24.95)	.750(19.05)	.817(20.74)	23
18	FID12707-184R1L	1.082(27.49)	.850(21.59)	.917(23.28)	21
20	FID12707-204R1L	1.182(30.03)	.950(24.13)	1.017(25.82)	19
22	FID12707-224R1L	1.282(32.57)	1.050(26.67)	1.117(28.36)	17
24	FID12707-244R1L	1.382(35.11)	1.150(29.21)	1.217(30.90)	16
26	FID12707-264R1L	1.482(37.65)	1.250(31.75)	1.317(33.44)	15

**Ordering Information**

FID 127 07 — XX 4 R1 X  
1 2 3 4 5 6 7

1 Category FID-IDC	2 Series Number 127-Pitch1.27mm	3 Distinction No. 07	4 Circuits XX	5 Plating 4-Tin Plated All	6 Color-Resin R1-Red	7 Packaging M-Reel L-Tube
-----------------------	------------------------------------	-------------------------	------------------	-------------------------------	-------------------------	---------------------------------

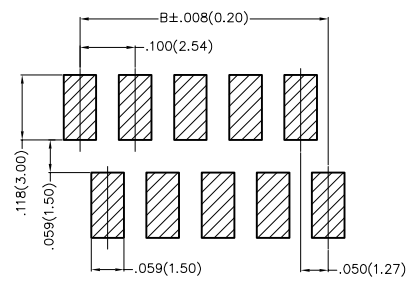

Recommended P.C.Board Layout

THIRD ANGLE PROJECTION	GENERAL TOLERANCES (UNLESS SPECIFIED)		APPROVE BY FRANK	DATE 9/SEPT/13	PART NO. FID12707-XX4R1X	ITEM NO. FID12707	 Building Technology Cornerstone
	DESIGN UNITS Inch (metric)	X±.015(0.38)	X'±5'	CHECKED BY CHERRY	DATE 9/SEPT/13	TITLE Wire to Board(Micro Match IDC) Pitch 1.27mm 180° Vertical (SMT)	
SCALE 5:1		SIZE A4	X.XX±.010(0.25)	.XX'±1'	DRAWN BY JACOB	DATE 9/SEPT/13	THIS DRAWING CONTAINS INFORMATION THAT IS PROPRIETARY TO TXGA INDUSTRIAL ELECTRONICS(S.Z)CO.,LTD AND SHOULD NOT BE USED WITHOUT WRITTEN PERMISSION
		X.XXX±.004(0.10)	.XXX'±0.5'			REV 1	SHEET NO. 1/1